

(A) SHIPLAP (VERTICAL OR HORIZONTAL)

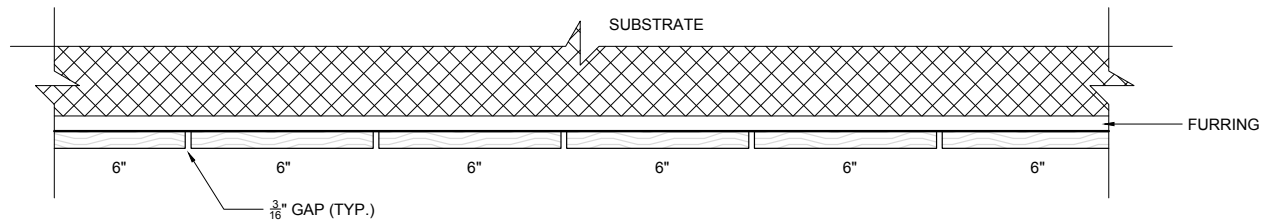

(B) 6" OPEN SCREEN, 6" S3S

NOTE: BE SURE TO HAVE A BLACK SUBSTRATE

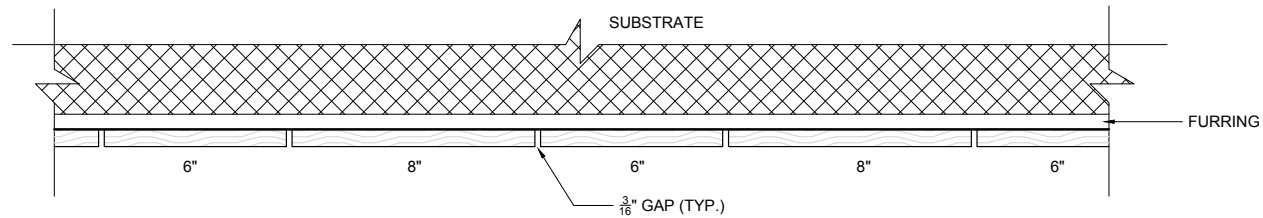

(C) 6" & 8" OPEN SCREEN, 6" & 8" S3S

GENERAL NOTES:

1. RECOMMENDED PANEL DETAIL EXAMPLES MUST BE ADAPTED FOR VERTICAL AND OTHER INSTALL LAYOUTS.
2. FURRING AND HEADED FACE NAILS REQUIRED FOR ALL EXTERIOR INSTALLATIONS.
3. VERIFY ALL DIMENSIONS AND ELEVATIONS. THESE DETAILS ARE NOT FOR CONSTRUCTION.
4. NAKAMOTO FORESTRY TAKES NO RESPONSIBILITY FOR THE DESIGN AND CONSTRUCTION OF CUSTOMER PROJECTS. THESE DRAWINGS ARE FOR EXAMPLE REFERENCE ONLY.

NOT FOR CONSTRUCTION



Tel. +1-503-512-6780
 Fax +1-503-828-3665
 Email: info@nakamotoforestry.com
 Warehouse & Office - (by Appt. ONLY)
 6400 SE 101st Ave Unit 2C
 Portland OR 97266

Project Title:		Project No.
SIDING & PANELING LAYOUT SUGGESTIONS		000-000
No. Revision Date		Drawn By:
#2	12/02/2019	PLM
Description		Date:
Beleck Rev.		11/20/2019
		Drawing No.
		N1.10

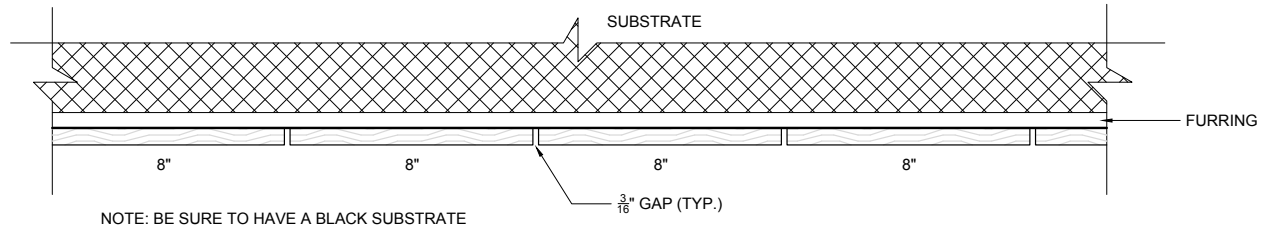

(A) 8" OPEN SCREEN, 8" S3S

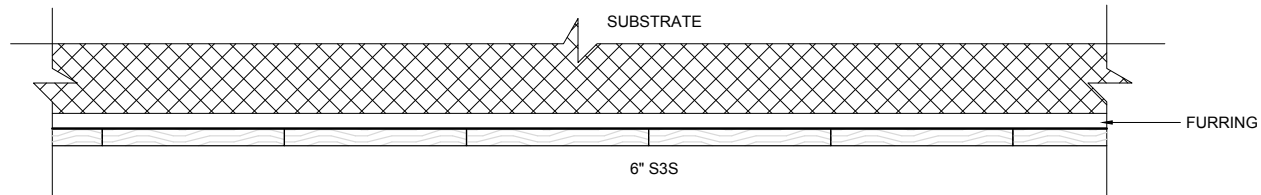

(B) 6" CLOSED SCREEN, 6" S3S

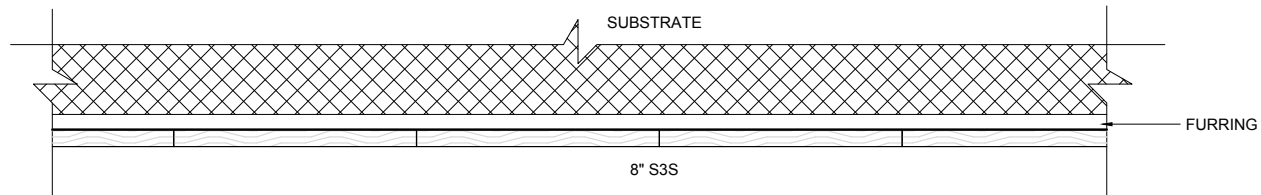

(C) 8" CLOSED SCREEN, 8" S3S

GENERAL NOTES:

1. RECOMMENDED PANEL DETAIL EXAMPLES MUST BE ADAPTED FOR VERTICAL AND OTHER INSTALL LAYOUTS.
2. FURRING AND HEADED FACE NAILS REQUIRED FOR ALL EXTERIOR INSTALLATIONS.
3. VERIFY ALL DIMENSIONS AND ELEVATIONS.
4. THESE DETAILS ARE NOT FOR CONSTRUCTION. NAKAMOTO FORESTRY TAKES NO RESPONSIBILITY FOR THE DESIGN AND CONSTRUCTION OF CUSTOMER PROJECTS. THESE DRAWINGS ARE FOR EXAMPLE REFERENCE ONLY.

NOT FOR CONSTRUCTION



Tel. +1-503-512-6780
 Fax +1-503-828-3665
 Email: info@nakamotoforestry.com
 Warehouse & Office - (by Appt. ONLY)
 6400 SE 101st Ave Unit 2C
 Portland OR 97266

Project Title:		Project No.
SIDING & PANELING LAYOUT SUGGESTIONS		000-000
No.		Revision Date
#2	12/02/2019	Beleck Rev.
Drawing No.		
		N1.11

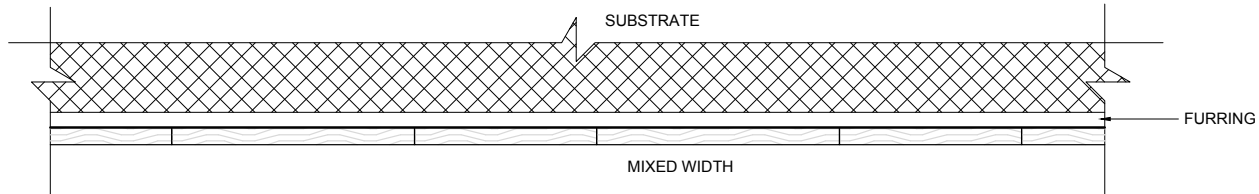

A 6" & 8" CLOSED SCREEN, 6" & 8" S3S

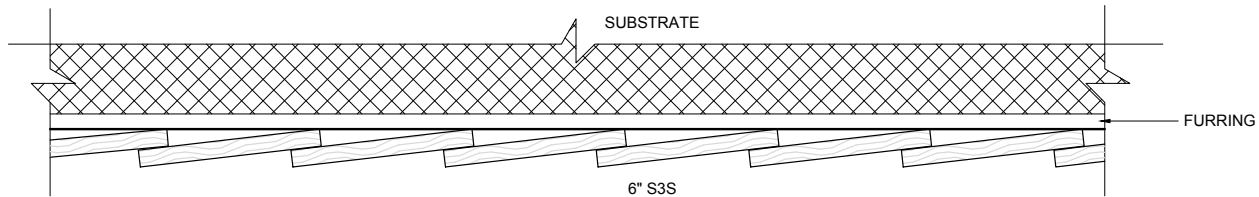

NOTE: OVERLAP MINIMUM 1"
 BE AWARE THAT LATERAL CUPPING IS LIKELY WITH THIS LAYOUT

B 6" VERTICAL OR HORIZONTAL CLAPBOARD

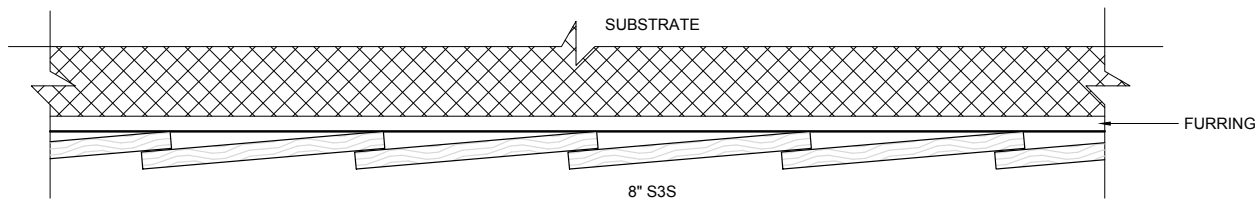

NOTE: OVERLAP MINIMUM 1.5"
 BE AWARE THAT LATERAL CUPPING IS LIKELY WITH THIS LAYOUT

C 8" VERTICAL OR HORIZONTAL CLAPBOARD

GENERAL NOTES:

1. RECOMMENDED PANEL DETAIL EXAMPLES MUST BE ADAPTED FOR VERTICAL AND OTHER INSTALL LAYOUTS.
2. FURRING AND HEADED FACE NAILS REQUIRED FOR ALL EXTERIOR INSTALLATIONS.
3. VERIFY ALL DIMENSIONS AND ELEVATIONS.
4. THESE DETAILS ARE NOT FOR CONSTRUCTION. NAKAMOTO FORESTRY TAKES NO RESPONSIBILITY FOR THE DESIGN AND CONSTRUCTION OF CUSTOMER PROJECTS. THESE DRAWINGS ARE FOR EXAMPLE REFERENCE ONLY.

NOT FOR CONSTRUCTION



Tel. +1-503-512-6780
 Fax +1-503-828-3665
 Email: info@nakamotoforestry.com
 Warehouse & Office - (by Appt. ONLY)
 6400 SE 101st Ave Unit 2C
 Portland OR 97266

Project Title:		Project No.
SIDING & PANELING LAYOUT SUGGESTIONS		000-000
No.		Revision Date
#3	02/18/2020	Beleck Rev.
Drawing No.		N1.12

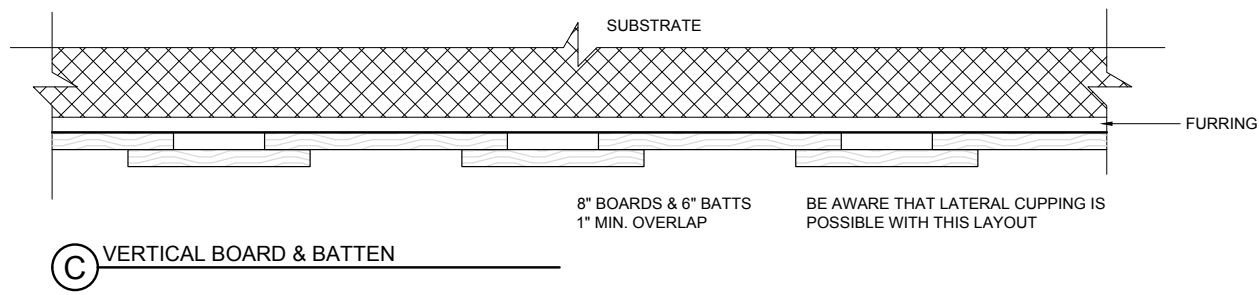
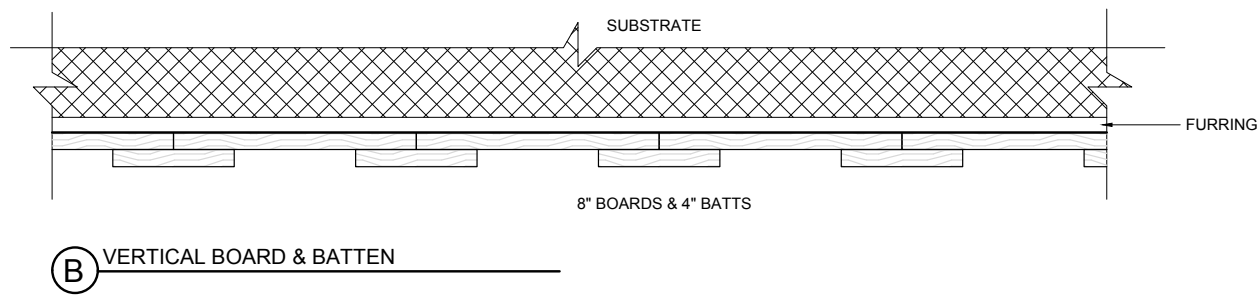
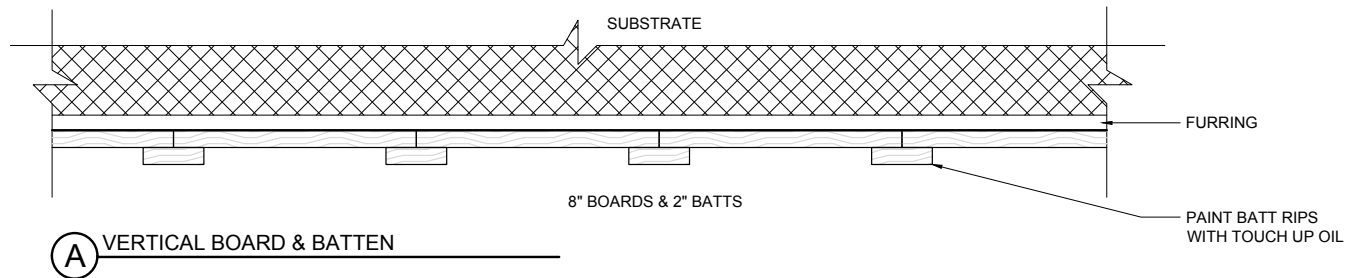

GENERAL NOTES:

1. RECOMMENDED PANEL DETAIL EXAMPLES MUST BE ADAPTED FOR VERTICAL AND OTHER INSTALL LAYOUTS.
2. FURRING AND HEADED FACE NAILS REQUIRED FOR ALL EXTERIOR INSTALLATIONS.
3. VERIFY ALL DIMENSIONS AND ELEVATIONS.
4. THESE DETAILS ARE NOT FOR CONSTRUCTION. NAKAMOTO FORESTRY TAKES NO RESPONSIBILITY FOR THE DESIGN AND CONSTRUCTION OF CUSTOMER PROJECTS. THESE DRAWINGS ARE FOR EXAMPLE REFERENCE ONLY.

NOT FOR CONSTRUCTION



Tel. +1-503-512-6780
 Fax +1-503-828-3665
 Email: info@nakamotoforestry.com
 Warehouse & Office - (by Appt. ONLY)
 6400 SE 101st Ave Unit 2C
 Portland OR 97266

Project Title:		Project No.
SIDING & PANELING LAYOUT SUGGESTIONS		000-000
No.		Revision Date
Description		Drawn By:
#3		PLM
02/20/2020		Date:
Beleck Rev.		11/20/2019
Drawing No.		
		N1.13

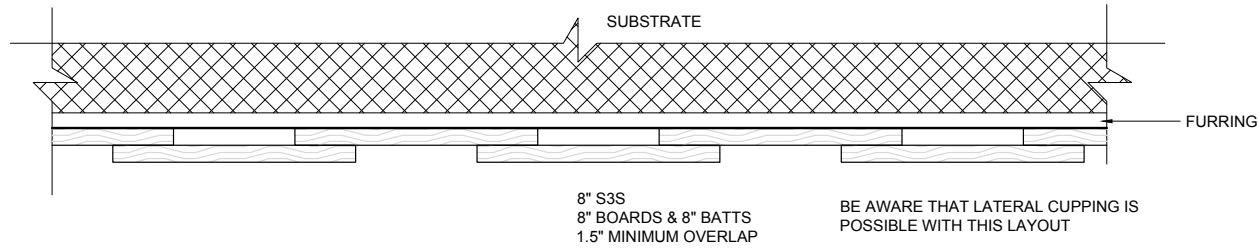

(A) VERTICAL BOARD & BATTEN

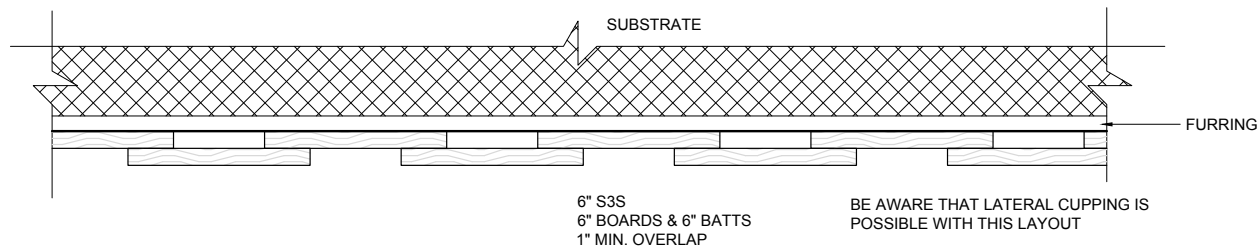

(B) VERTICAL BOARD & BATTEN

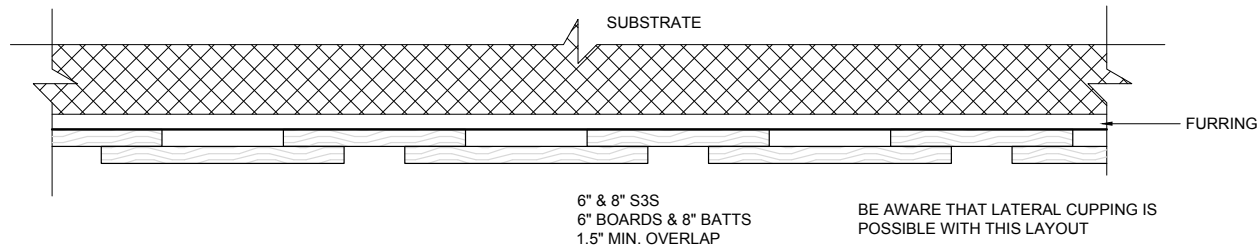

(C) VERTICAL REVERSE BOARD & BATTEN

GENERAL NOTES:

1. RECOMMENDED PANEL DETAIL EXAMPLES MUST BE ADAPTED FOR VERTICAL AND OTHER INSTALL LAYOUTS.
2. FURRING AND HEADED FACE NAILS REQUIRED FOR ALL EXTERIOR INSTALLATIONS.
3. VERIFY ALL DIMENSIONS AND ELEVATIONS.
4. THESE DETAILS ARE NOT FOR CONSTRUCTION. NAKAMOTO FORESTRY TAKES NO RESPONSIBILITY FOR THE DESIGN AND CONSTRUCTION OF CUSTOMER PROJECTS. THESE DRAWINGS ARE FOR EXAMPLE REFERENCE ONLY.

NOT FOR CONSTRUCTION



Tel. +1-503-512-6780
 Fax +1-503-828-3665
 Email: info@nakamotoforestry.com
 Warehouse & Office - (by Appt. ONLY)
 6400 SE 101st Ave Unit 2C
 Portland OR 97266

Project Title:		Project No.
SIDING & PANELING LAYOUT SUGGESTIONS		000-000
No.		Revision Date
Description		Drawn By:
#4		02/20/2020
Beleck Rev.		Date:
Drawing No.		11/20/2019
		N1.14

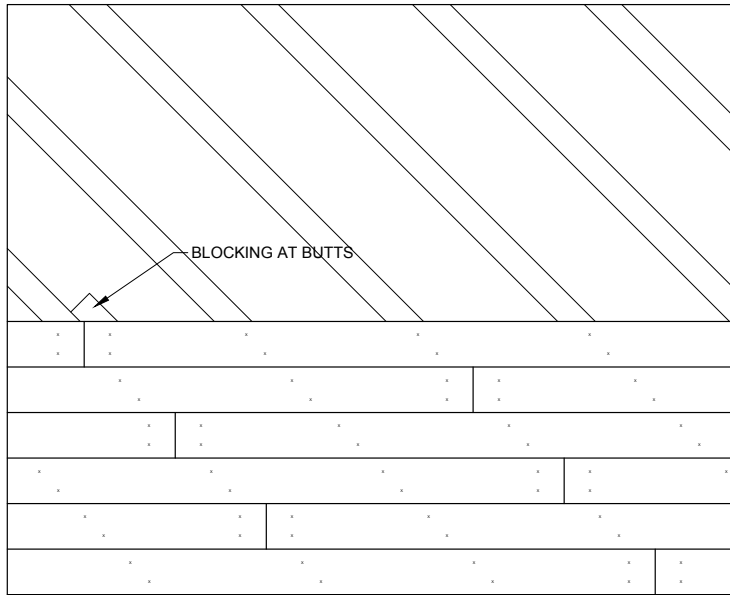

DIAGONAL FURRING
VENTED TOP, BOTTOM,
CORNERS, AND PENETRATIONS

A RAIN SCREEN FURRING LAYOUT SUGGESTIONS

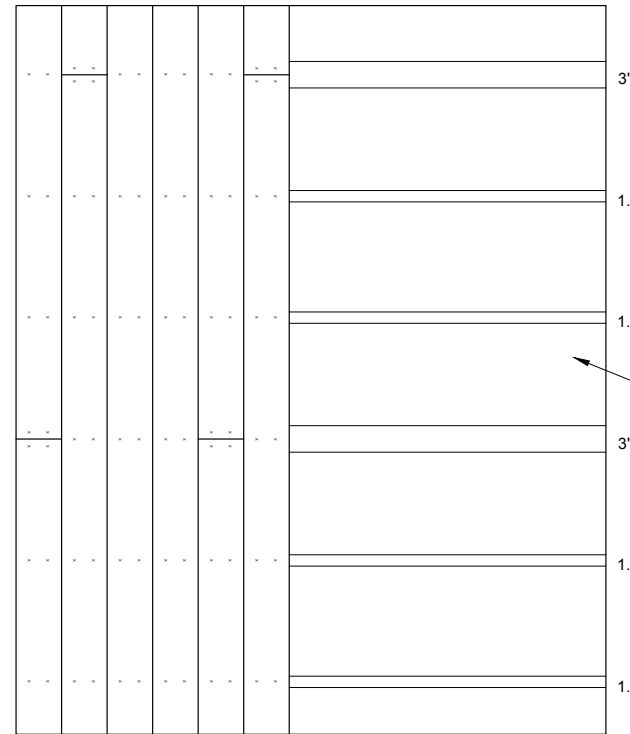

VERTICAL FURRING
3" MINIMUM FURRING WIDTH
FOR BUTTS
1.5" MINIMUM FURRING WIDTH
FOR INTERMEDIATE STRIPPING
VENTED OUT CORNERS AND
PENETRATIONS

B SIDING & PANELING LAYOUT SUGGESTIONS

GENERAL NOTES:

1. RECOMMENDED PANEL DETAIL EXAMPLES MUST BE ADAPTED FOR VERTICAL AND OTHER INSTALL LAYOUTS.
2. FURRING AND HEADED FACE NAILS REQUIRED FOR ALL EXTERIOR INSTALLATIONS.
3. VERIFY ALL DIMENSIONS AND ELEVATIONS. THESE DETAILS ARE NOT FOR CONSTRUCTION.
4. NAKAMOTO FORESTRY TAKES NO RESPONSIBILITY FOR THE DESIGN AND CONSTRUCTION OF CUSTOMER PROJECTS. THESE DRAWINGS ARE FOR EXAMPLE REFERENCE ONLY.

NOT FOR CONSTRUCTION



Tel. +1-503-512-6780
Fax +1-503-828-3665
Email: info@nakamotoforestry.com
Warehouse & Office - (by Appt. ONLY)
6400 SE 101st Ave Unit 2C
Portland OR 97266

Project Title:		Project No.
RAIN SCREEN FURRING LAYOUT SUGGESTIONS		000-000
No.		Revision Date
#2	12/02/2019	Beleck Rev.
Description		Project No.
		000-000
Drawing No.		Drawn By:
N1.15		PLM
		Date:
		11/20/2019

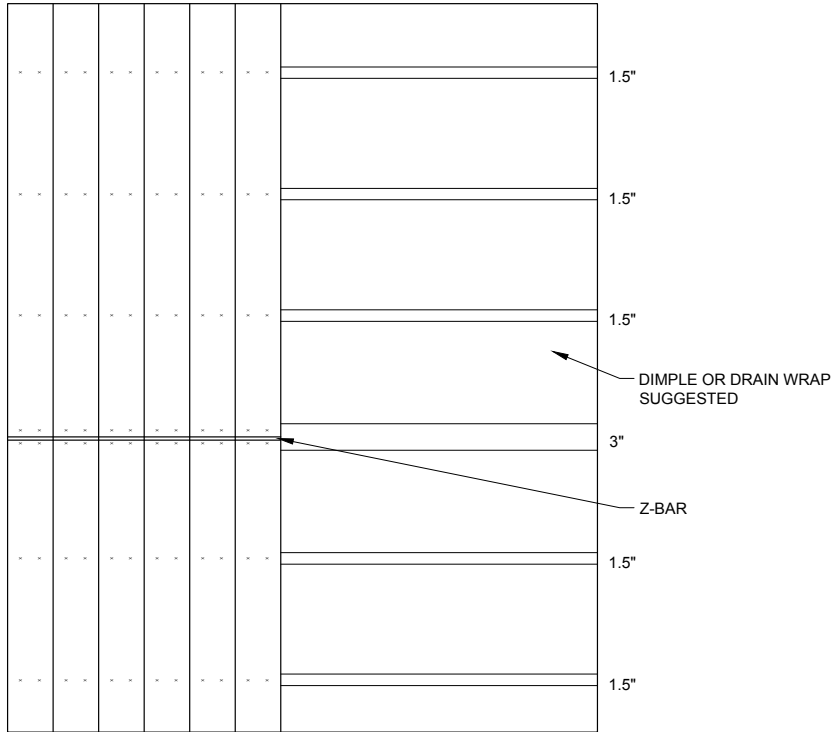

VERTICAL FURRING
 3" MINIMUM FURRING WIDTH
 FOR BUTTS
 1.5" MINIMUM FURRING WIDTH
 FOR INTERMEDIATE STRIPPING
 VENTED OUT CORNERS AND
 PENETRATIONS
 PLEASE USE Z-BAR AT BOND
 LINES

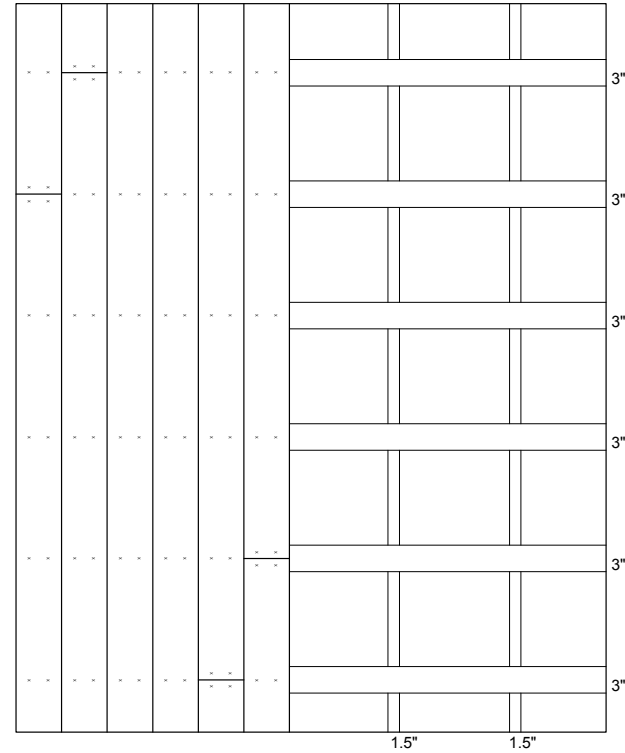

GRID FURRING (REQUIRED BY
 SOME MUNICIPALITIES)

A SIDING & PANELING LAYOUT SUGGESTIONS

B SIDING & PANELING LAYOUT SUGGESTIONS

GENERAL NOTES:

1. RECOMMENDED PANEL DETAIL EXAMPLES MUST BE ADAPTED FOR VERTICAL AND OTHER INSTALL LAYOUTS.
2. FURRING AND HEADED FACE NAILS REQUIRED FOR ALL EXTERIOR INSTALLATIONS.
3. VERIFY ALL DIMENSIONS AND ELEVATIONS. THESE DETAILS ARE NOT FOR CONSTRUCTION.
4. NAKAMOTO FORESTRY TAKES NO RESPONSIBILITY FOR THE DESIGN AND CONSTRUCTION OF CUSTOMER PROJECTS. THESE DRAWINGS ARE FOR EXAMPLE REFERENCE ONLY.

NOT FOR CONSTRUCTION



Tel. +1-503-512-6780
 Fax +1-503-828-3665
 Email: info@nakamotoforestry.com
 Warehouse & Office - (by Appt. ONLY)
 6400 SE 101st Ave Unit 2C
 Portland OR 97266

Project Title: RAIN SCREEN FURRING LAYOUT SUGGESTIONS			Project No. 000-000
			Drawn By: PLM
			Date: 11/20/2019
No.	Revision Date	Description	Drawing No.
#2	12/02/2019	Beleck Rev.	N1.16

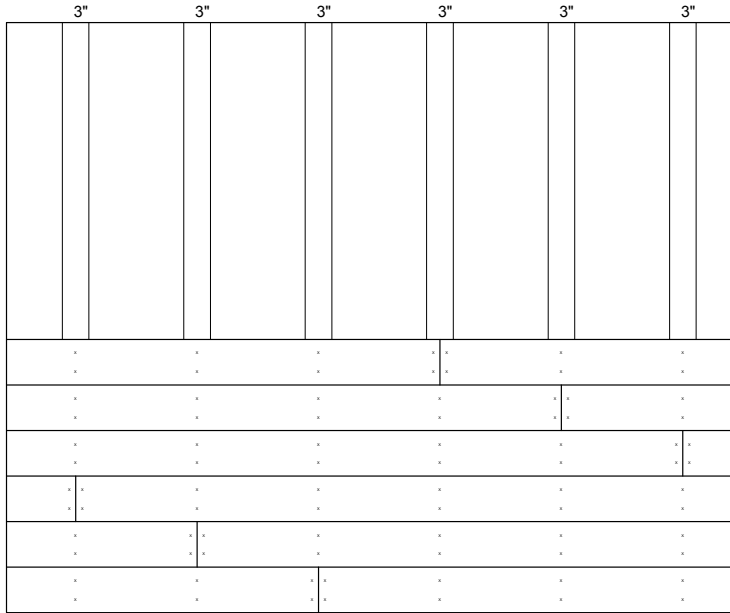

VERTICAL FURRING
3" MINIMUM FURRING WITH
STAGGERED BUTTS

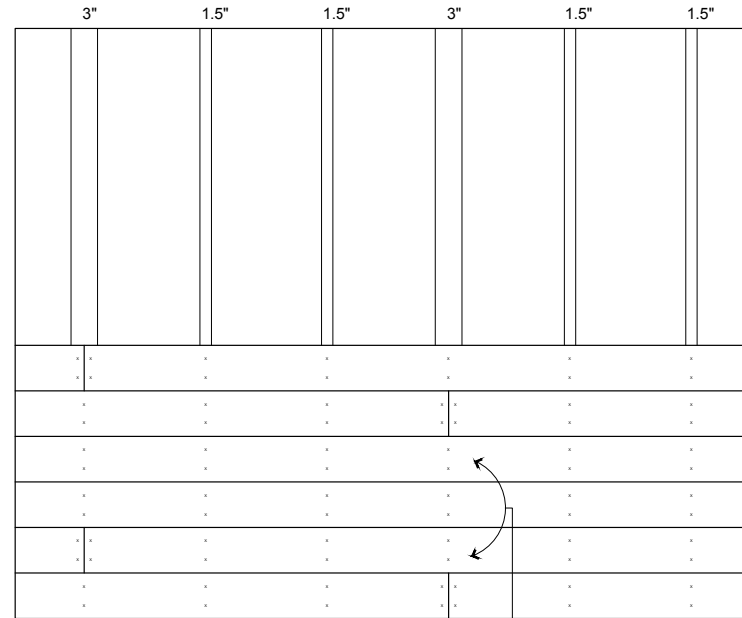

VERTICAL FURRING
3" MINIMUM FURRING WIDTH
FOR BUTTS
1.5" MINIMUM FURRING WIDTH
FOR INTERMEDIATE STRIPPING

MINIMUM 2 UNBROKEN ROWS
BETWEEN BUTTS FOR BEST
APPEARANCE

A SIDING & PANELING LAYOUT SUGGESTIONS

B RAIN SCREEN FURRING LAYOUT SUGGESTIONS

GENERAL NOTES:

1. RECOMMENDED PANEL DETAIL EXAMPLES MUST BE ADAPTED FOR VERTICAL AND OTHER INSTALL LAYOUTS.
2. FURRING AND HEADED FACE NAILS REQUIRED FOR ALL EXTERIOR INSTALLATIONS.
3. VERIFY ALL DIMENSIONS AND ELEVATIONS. THESE DETAILS ARE NOT FOR CONSTRUCTION.
4. NAKAMOTO FORESTRY TAKES NO RESPONSIBILITY FOR THE DESIGN AND CONSTRUCTION OF CUSTOMER PROJECTS. THESE DRAWINGS ARE FOR EXAMPLE REFERENCE ONLY.

NOT FOR CONSTRUCTION



Tel. +1-503-512-6780
Fax +1-503-828-3665
Email: info@nakamotoforestry.com
Warehouse & Office - (by Appt. ONLY)
6400 SE 101st Ave Unit 2C
Portland OR 97266

Project Title:		Project No.
RAIN SCREEN FURRING LAYOUT SUGGESTIONS		000-000
No.		Revision Date
#3		02/18/2020
Description		Beleck Rev.
Drawing No.		N1.17
Drawn By:		PLM
Date:		11/20/2019

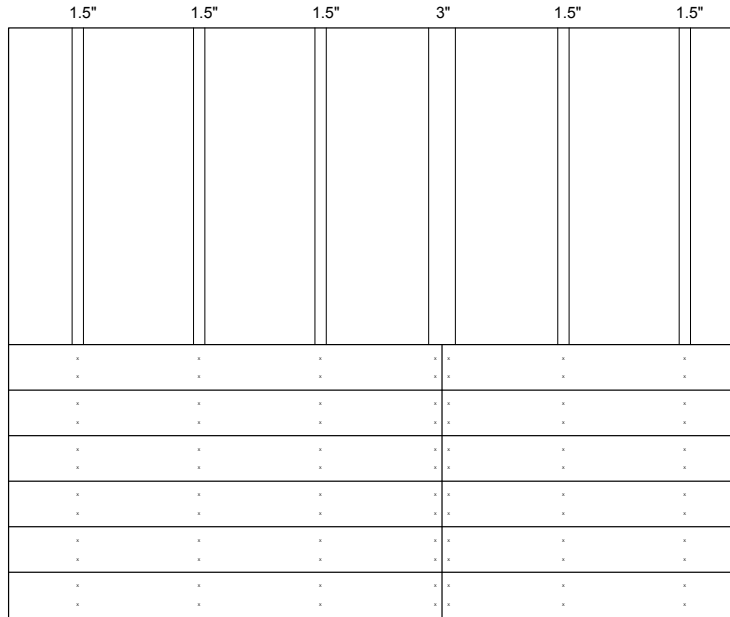

VERTICAL FURRING
 3" MINIMUM FURRING WIDTH
 FOR BUTTS
 1.5" MINIMUM FURRING WIDTH
 FOR INTERMEDIATE STRIPPING
 STRAIGHT BOND LINE

A SIDING & PANELING LAYOUT SUGGESTIONS

GENERAL NOTES:

1. RECOMMENDED PANEL DETAIL EXAMPLES MUST BE ADAPTED FOR VERTICAL AND OTHER INSTALL LAYOUTS.
2. FURRING AND HEADED FACE NAILS REQUIRED FOR ALL EXTERIOR INSTALLATIONS.
3. VERIFY ALL DIMENSIONS AND ELEVATIONS.
4. THESE DETAILS ARE NOT FOR CONSTRUCTION. NAKAMOTO FORESTRY TAKES NO RESPONSIBILITY FOR THE DESIGN AND CONSTRUCTION OF CUSTOMER PROJECTS. THESE DRAWINGS ARE FOR EXAMPLE REFERENCE ONLY.

NOT FOR CONSTRUCTION



Tel. +1-503-512-6780
 Fax +1-503-828-3665
 Email: info@nakamotoforestry.com
 Warehouse & Office - (by Appt. ONLY)
 6400 SE 101st Ave Unit 2C
 Portland OR 97266

Project Title:		Project No.
RAIN SCREEN FURRING LAYOUT SUGGESTIONS		000-000
No.		Revision Date
Description		Drawn By: PLM
		Date: 11/20/2019
		Drawing No.
		N1.18

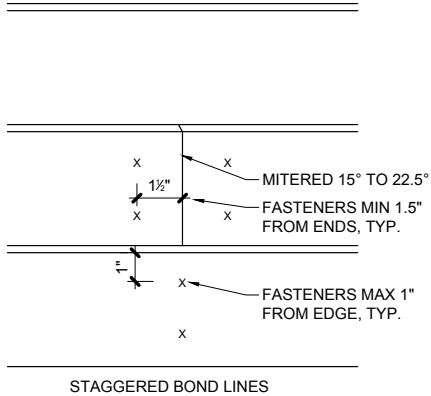

A HORIZONTAL LAYOUT SCARF JOINT

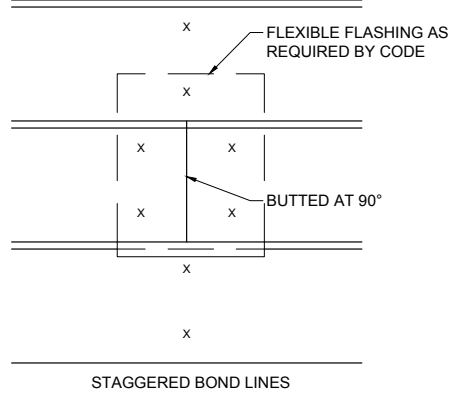

B HORIZONTAL LAYOUT BUTT JOINT

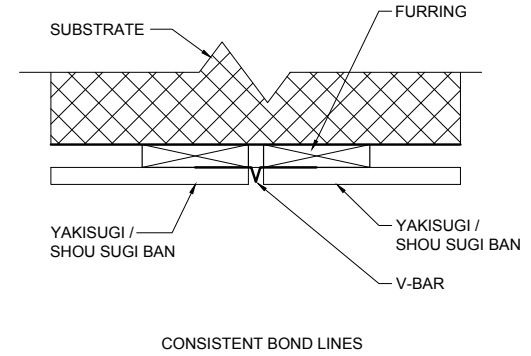

C PLAN VIEW - HORIZONTAL LAYOUT

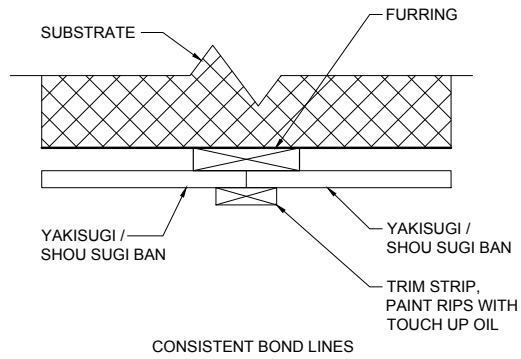

D PLAN VIEW - HORIZONTAL LAYOUT

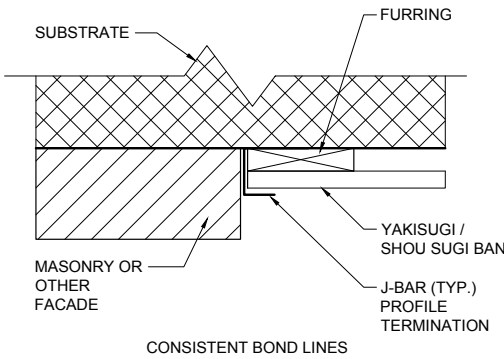

E PLAN VIEW - HORIZONTAL LAYOUT

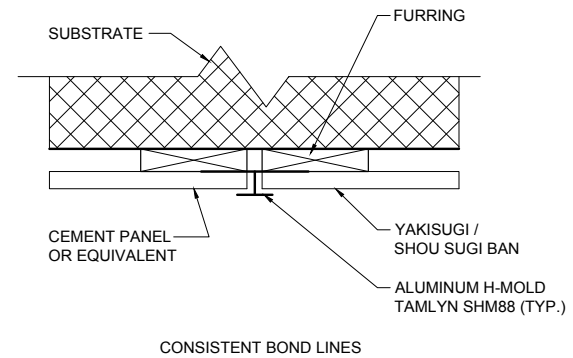

F PLAN VIEW - HORIZONTAL LAYOUT

GENERAL NOTES:

1. RECOMMENDED PANEL DETAIL EXAMPLES MUST BE ADAPTED FOR VERTICAL AND OTHER INSTALL LAYOUTS.
2. FURRING AND HEADED FACE NAILS REQUIRED FOR ALL EXTERIOR INSTALLATIONS.
3. VERIFY ALL DIMENSIONS AND ELEVATIONS.
4. THESE DETAILS ARE NOT FOR CONSTRUCTION. NAKAMOTO FORESTRY TAKES NO RESPONSIBILITY FOR THE DESIGN AND CONSTRUCTION OF CUSTOMER PROJECTS. THESE DRAWINGS ARE FOR EXAMPLE REFERENCE ONLY.

NOT FOR CONSTRUCTION



Tel. +1-503-512-6780
 Fax +1-503-828-3665
 Email: info@nakamotoforestry.com
 Warehouse & Office - (by Appt. ONLY)
 6400 SE 101st Ave Unit 2C
 Portland OR 97266

Project Title: EXTERIOR BOND LINE DETAIL		Project No. 000-000
		Drawn By: PLM
		Date: 01/09/2020
No.	Revision Date	Description
#9	02/20/2020	Beleck Rev.
		Drawing No. N1.02

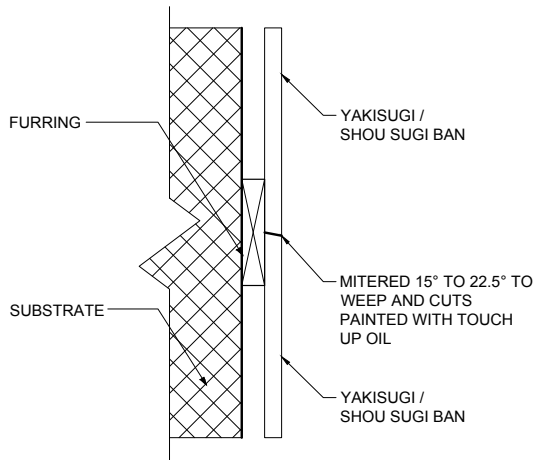

(A) VERTICAL LAYOUT SCARF JOINT

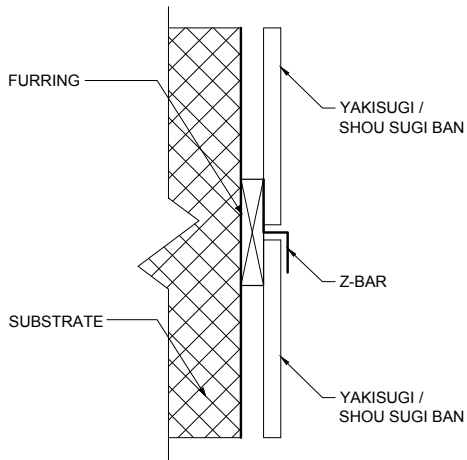

(B) VERTICAL LAYOUT BUTT JOINT

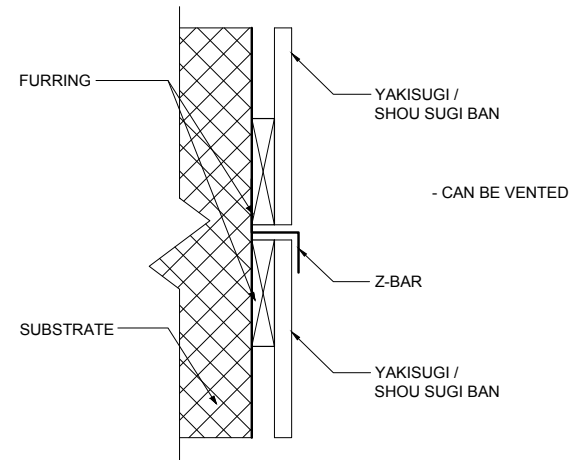

(C) VERTICAL LAYOUT BUTT JOINT

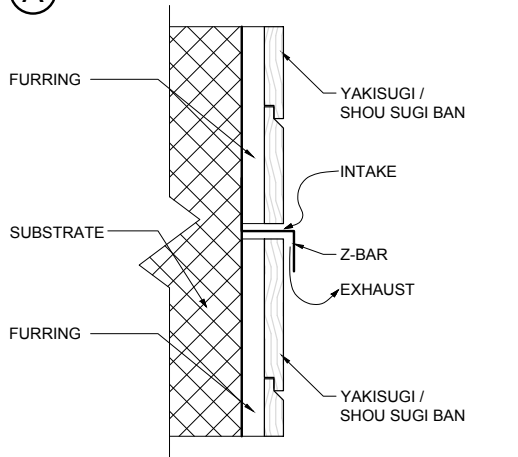

(D) HORIZONTAL LAYOUT BOND LINE VENTING

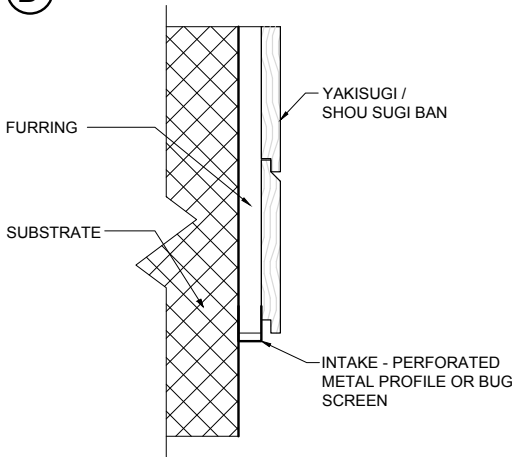

(E) HORIZONTAL INSTALL DRIP INTAKE

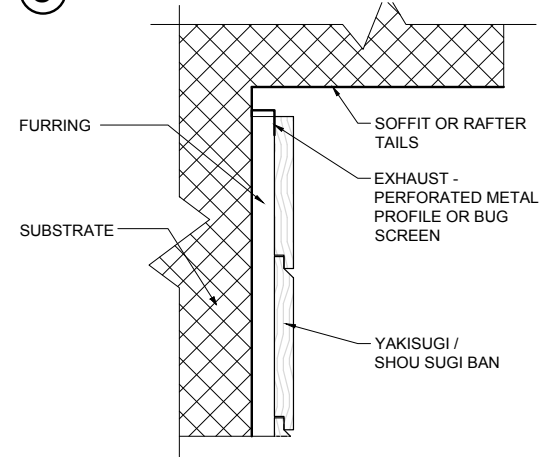

(F) VENTING AT SOFFIT OR RAFTER

GENERAL NOTES:

1. RECOMMENDED PANEL DETAIL EXAMPLES MUST BE ADAPTED FOR VERTICAL AND OTHER INSTALL LAYOUTS.
2. FURRING AND HEADED FACE NAILS REQUIRED FOR ALL EXTERIOR INSTALLATIONS.
3. VERIFY ALL DIMENSIONS AND ELEVATIONS.
4. THESE DETAILS ARE NOT FOR CONSTRUCTION. NAKAMOTO FORESTRY TAKES NO RESPONSIBILITY FOR THE DESIGN AND CONSTRUCTION OF CUSTOMER PROJECTS. THESE DRAWINGS ARE FOR EXAMPLE REFERENCE ONLY.

NOT FOR CONSTRUCTION



Tel. +1-503-512-6780
 Fax +1-503-828-3665
 Email: info@nakamotoforestry.com
 Warehouse & Office - (by Appt. ONLY)
 6400 SE 101st Ave Unit 2C
 Portland OR 97266

Project Title: EXTERIOR BOND LINE DETAIL		Project No. 000-000
		Drawn By: PLM
		Date: 01/09/2020
No.	Revision Date	Description
#9	02/19/2020	Beleck Rev.
		Drawing No. N1.01

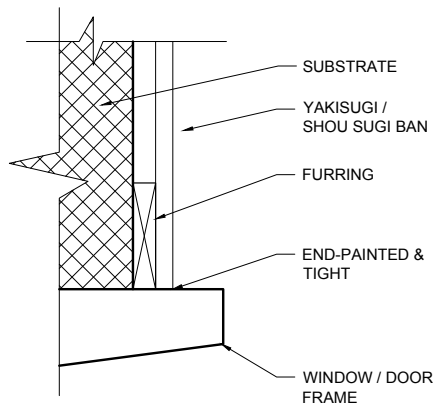

A PLAN VIEW - DOOR & WINDOW PENETRATION

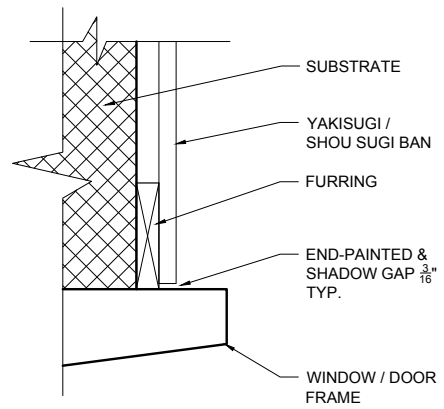

B PLAN VIEW - DOOR & WINDOW PENETRATION

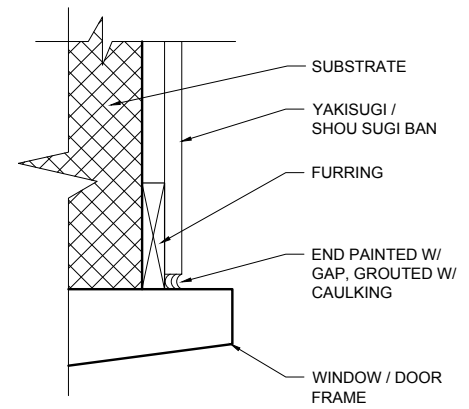

C PLAN VIEW - DOOR & WINDOW PENETRATION

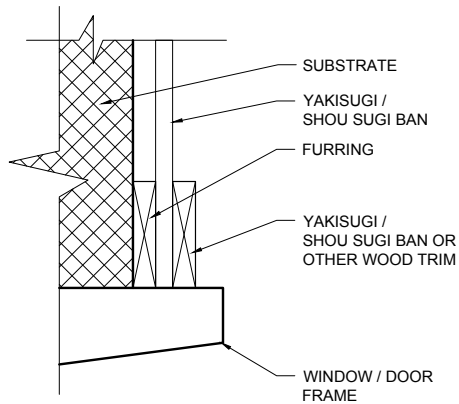

D PLAN VIEW - DOOR & WINDOW PENETRATION

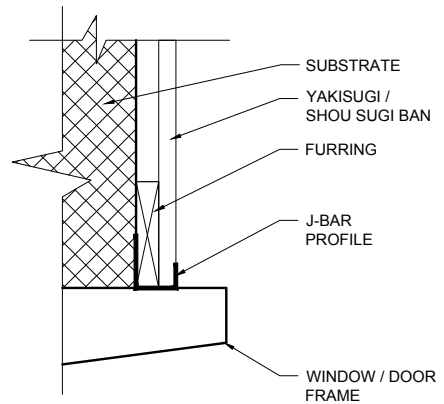

E PLAN VIEW - DOOR & WINDOW PENETRATION

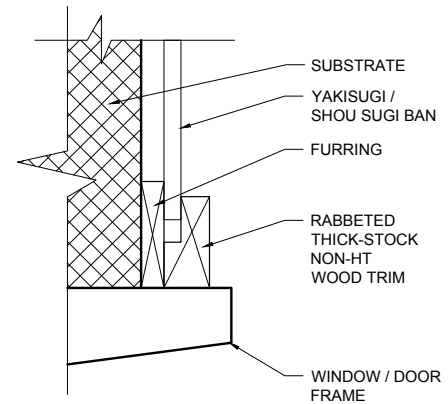

F PLAN VIEW - DOOR & WINDOW PENETRATION

GENERAL NOTES:

1. RECOMMENDED PANEL DETAIL EXAMPLES MUST BE ADAPTED FOR VERTICAL AND OTHER INSTALL LAYOUTS.
2. FURRING AND HEADED FACE NAILS REQUIRED FOR ALL EXTERIOR INSTALLATIONS.
3. VERIFY ALL DIMENSIONS AND ELEVATIONS. THESE DETAILS ARE NOT FOR CONSTRUCTION.
4. NAKAMOTO FORESTRY TAKES NO RESPONSIBILITY FOR THE DESIGN AND CONSTRUCTION OF CUSTOMER PROJECTS. THESE DRAWINGS ARE FOR EXAMPLE REFERENCE ONLY.

NOT FOR CONSTRUCTION



Tel. +1-503-512-6780
 Fax +1-503-828-3665
 Email: info@nakamotoforestry.com
 Warehouse & Office - (by Appt. ONLY)
 6400 SE 101st Ave Unit 2C
 Portland OR 97266

Project Title:		Project No.
DOOR & WINDOW PENETRATION SUGGESTIONS - 1 OF 2 SHEETS		000-000
No.		Revision Date
#2	12/02/2019	Beleck Rev.
Drawing No.		N1.05

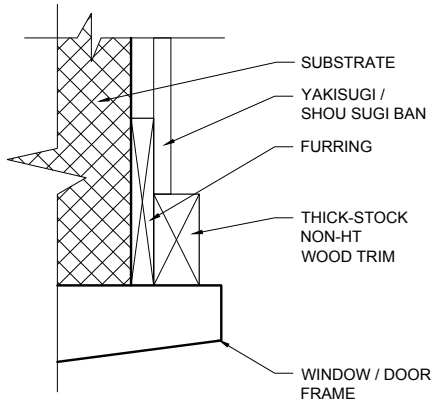

A PLAN VIEW - DOOR & WINDOW PENETRATION

GENERAL NOTES:

1. RECOMMENDED PANEL DETAIL EXAMPLES MUST BE ADAPTED FOR VERTICAL AND OTHER INSTALL LAYOUTS.
2. FURRING AND HEADED FACE NAILS REQUIRED FOR ALL EXTERIOR INSTALLATIONS.
3. VERIFY ALL DIMENSIONS AND ELEVATIONS.
4. THESE DETAILS ARE NOT FOR CONSTRUCTION. NAKAMOTO FORESTRY TAKES NO RESPONSIBILITY FOR THE DESIGN AND CONSTRUCTION OF CUSTOMER PROJECTS. THESE DRAWINGS ARE FOR EXAMPLE REFERENCE ONLY.

NOT FOR CONSTRUCTION



Tel. +1-503-512-6780
 Fax +1-503-828-3665
 Email: info@nakamotoforestry.com
 Warehouse & Office - (by Appt. ONLY)
 6400 SE 101st Ave Unit 2C
 Portland OR 97266

Project Title:		Project No.
DOOR & WINDOW PENETRATION SUGGESTIONS - 2 OF 2 SHEETS		000-000
No.		Revision Date
Description		Drawn By:
#3	12/02/2019	PLM
Beleck Rev.		Date:
		11/20/2019
		Drawing No.
		N1.06

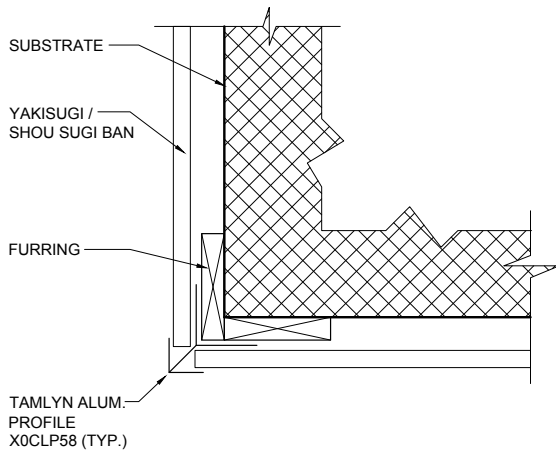

A PLAN VIEW - OUTSIDE CORNER - METAL

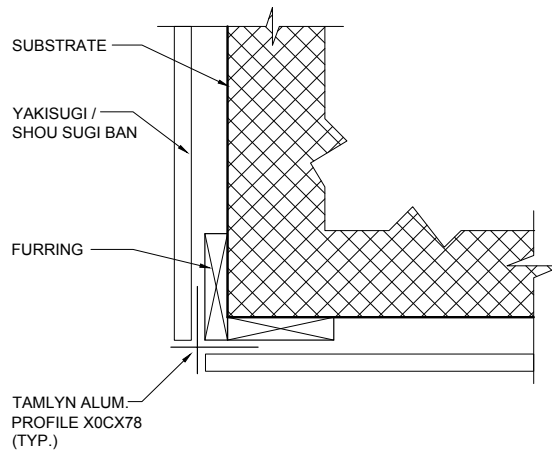

B PLAN VIEW - OUTSIDE CORNER - METAL

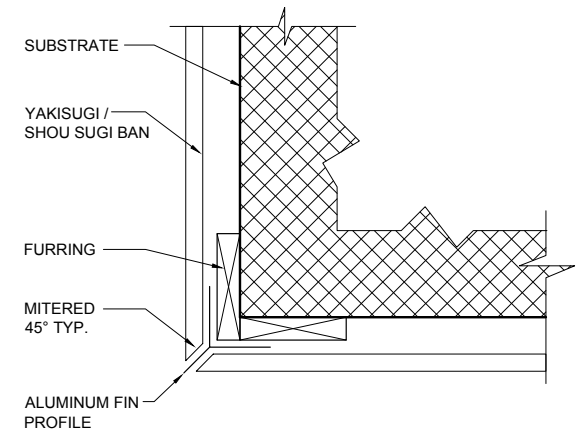

C PLAN VIEW - OUTSIDE CORNER - METAL

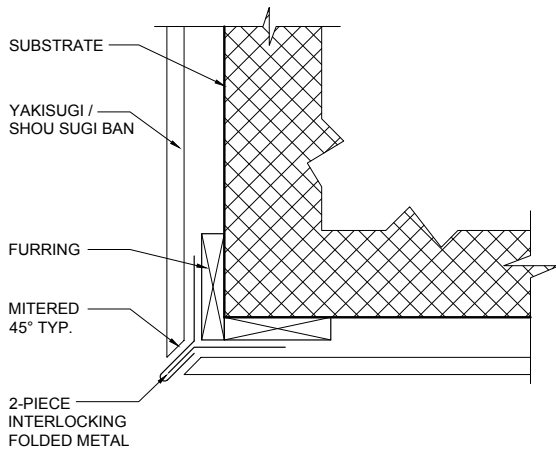

D PLAN VIEW - OUTSIDE CORNER - METAL

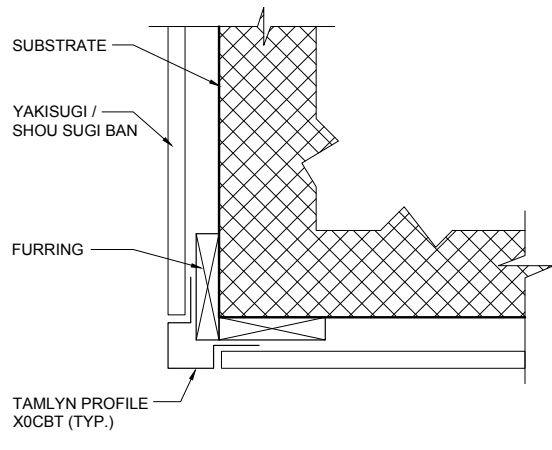

E PLAN VIEW - OUTSIDE CORNER - METAL

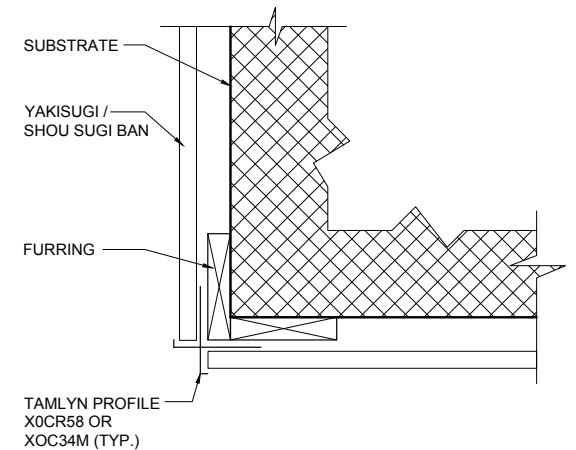

F PLAN VIEW - OUTSIDE CORNER - METAL

GENERAL NOTES:

1. RECOMMENDED PANEL DETAIL EXAMPLES MUST BE ADAPTED FOR VERTICAL AND OTHER INSTALL LAYOUTS.
2. FURRING AND HEADED FACE NAILS REQUIRED FOR ALL EXTERIOR INSTALLATIONS.
3. VERIFY ALL DIMENSIONS AND ELEVATIONS. THESE DETAILS ARE NOT FOR CONSTRUCTION.
4. NAKAMOTO FORESTRY TAKES NO RESPONSIBILITY FOR THE DESIGN AND CONSTRUCTION OF CUSTOMER PROJECTS. THESE DRAWINGS ARE FOR EXAMPLE REFERENCE ONLY.

NOT FOR CONSTRUCTION



Tel. +1-503-512-6780
 Fax +1-503-828-3665
 Email: info@nakamotoforestry.com
 Warehouse & Office - (by Appt. ONLY)
 6400 SE 101st Ave Unit 2C
 Portland OR 97266

Project Title:		Project No.
EXTERIOR OUTSIDE CORNER ALUMINUM & METAL OPTIONS		000-000
No.		Revision Date
#2	12/02/2019	Beleck Rev.
Description		Project No.
		000-000
		Drawn By:
		PLM
		Date:
		11/20/2019
		Drawing No.
		N1.07

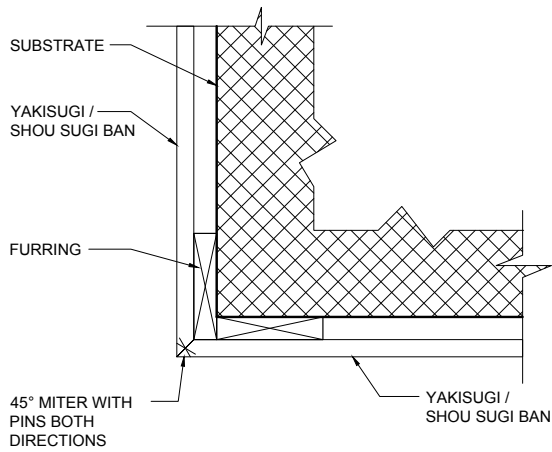

(A) PLAN VIEW - OUTSIDE CORNER - WOOD

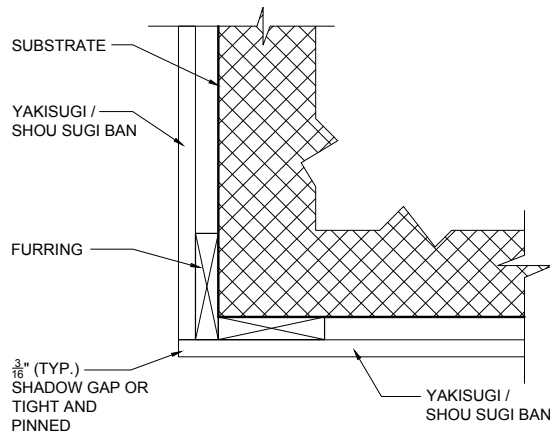

(B) PLAN VIEW - OUTSIDE CORNER - WOOD

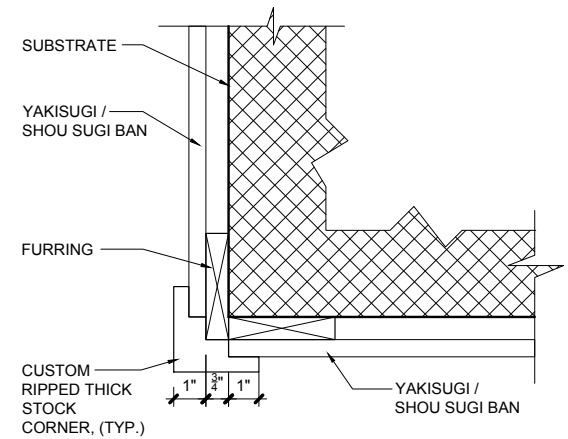

(C) PLAN VIEW - OUTSIDE CORNER - WOOD

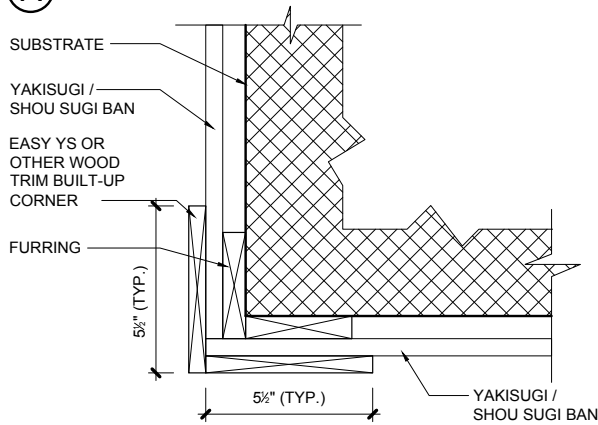

(D) PLAN VIEW - OUTSIDE CORNER - WOOD

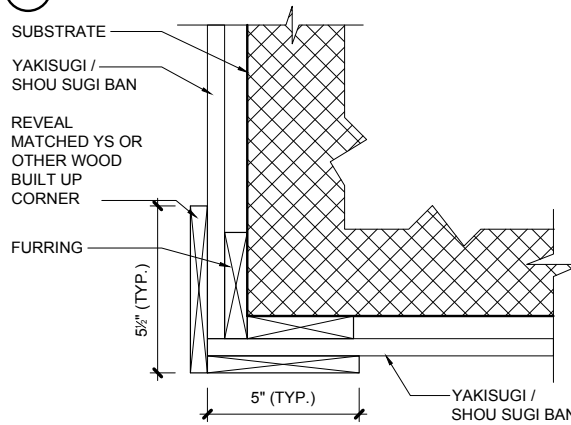

(E) PLAN VIEW - OUTSIDE CORNER - WOOD

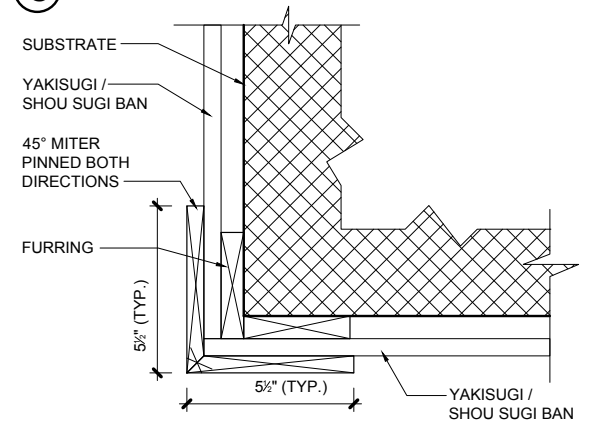

(F) PLAN VIEW - OUTSIDE CORNER - WOOD

GENERAL NOTES:

1. RECOMMENDED PANEL DETAIL EXAMPLES MUST BE ADAPTED FOR VERTICAL AND OTHER INSTALL LAYOUTS.
2. FURRING AND HEADED FACE NAILS REQUIRED FOR ALL EXTERIOR INSTALLATIONS.
3. VERIFY ALL DIMENSIONS AND ELEVATIONS.
4. THESE DETAILS ARE NOT FOR CONSTRUCTION. NAKAMOTO FORESTRY TAKES NO RESPONSIBILITY FOR THE DESIGN AND CONSTRUCTION OF CUSTOMER PROJECTS. THESE DRAWINGS ARE FOR EXAMPLE REFERENCE ONLY.

NOT FOR CONSTRUCTION



Tel. +1-503-512-6780
 Fax +1-503-828-3665
 Email: info@nakamotoforestry.com
 Warehouse & Office - (by Appt. ONLY)
 6400 SE 101st Ave Unit 2C
 Portland OR 97266

Project Title:		Project No.
EXTERIOR OUTSIDE CORNER WOOD OPTIONS - 1 OF 2 SHEETS		000-000
Drawn By:		PLM
Date:		11/20/2019
No.	Revision Date	Description
#2	12/02/2019	Beleck Rev.
Drawing No.		N1.08

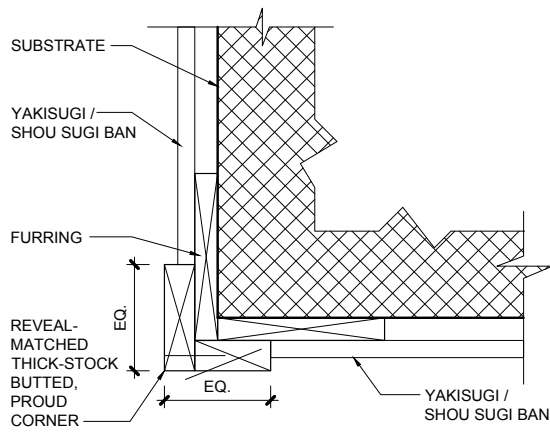

A PLAN VIEW - OUTSIDE CORNER - WOOD

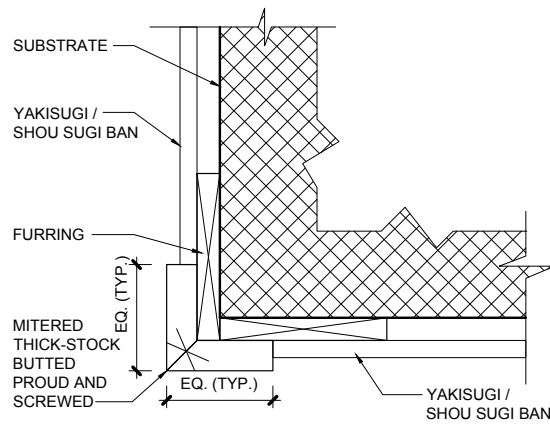

B PLAN VIEW - OUTSIDE CORNER - WOOD

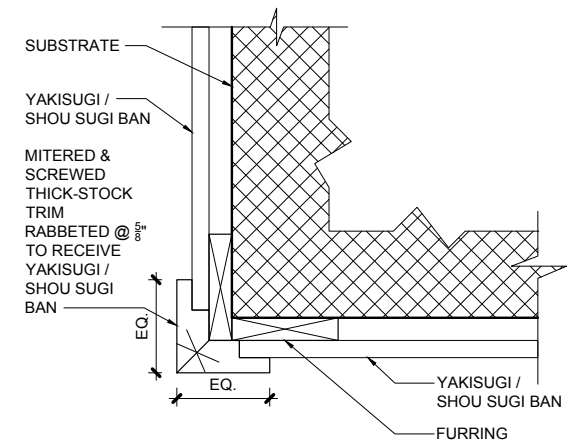

C PLAN VIEW - OUTSIDE CORNER - WOOD

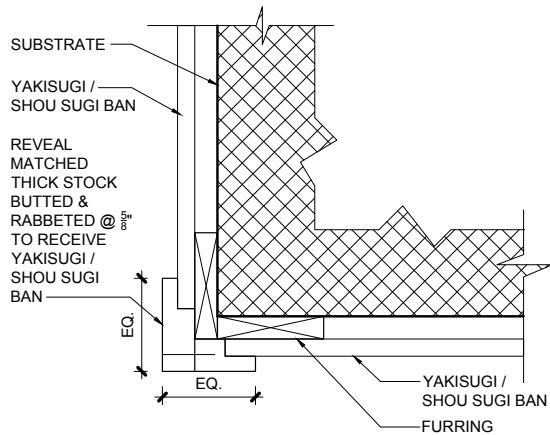

D PLAN VIEW - OUTSIDE CORNER - WOOD

GENERAL NOTES:

1. RECOMMENDED PANEL DETAIL EXAMPLES MUST BE ADAPTED FOR VERTICAL AND OTHER INSTALL LAYOUTS.
2. FURRING AND HEADED FACE NAILS REQUIRED FOR ALL EXTERIOR INSTALLATIONS.
3. VERIFY ALL DIMENSIONS AND ELEVATIONS.
4. THESE DETAILS ARE NOT FOR CONSTRUCTION. NAKAMOTO FORESTRY TAKES NO RESPONSIBILITY FOR THE DESIGN AND CONSTRUCTION OF CUSTOMER PROJECTS. THESE DRAWINGS ARE FOR EXAMPLE REFERENCE ONLY.

NOT FOR CONSTRUCTION



Tel. +1-503-512-6780
 Fax +1-503-828-3665
 Email: info@nakamotoforestry.com
 Warehouse & Office - (by Appt. ONLY)
 6400 SE 101st Ave Unit 2C
 Portland OR 97266

Project Title:		Project No.
EXTERIOR OUTSIDE CORNER WOOD OPTIONS, 2 OF 2 SHEETS		000-000
No.		Revision Date
#2	12/02/2019	Beleck Rev.
Description		Drawn By:
		PLM
		Date:
		11/20/2019
		Drawing No.
		N1.09

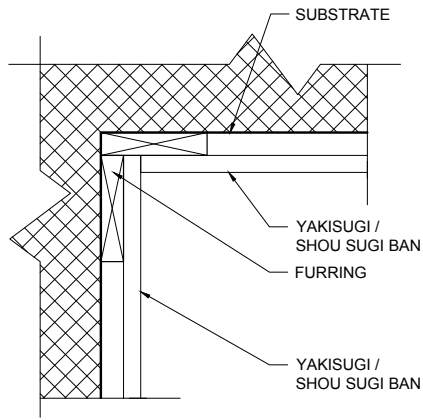

A PLAN VIEW INSIDE CORNER WOOD OPTIONS

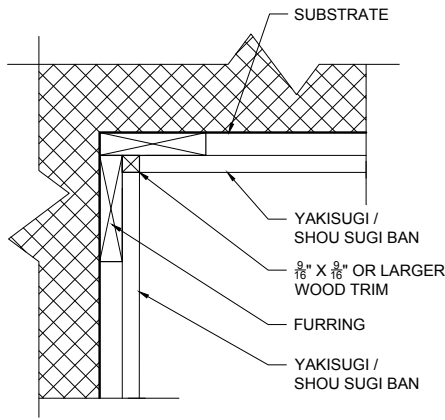

B PLAN VIEW INSIDE CORNER WOOD OPTIONS

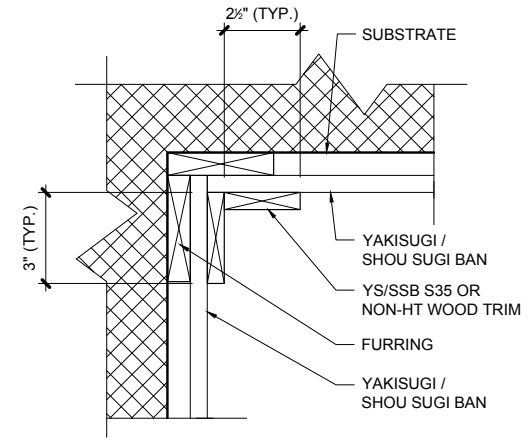

C PLAN VIEW INSIDE CORNER WOOD OPTIONS

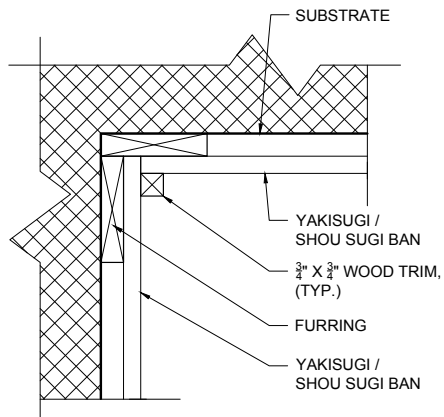

D PLAN VIEW INSIDE CORNER WOOD OPTIONS

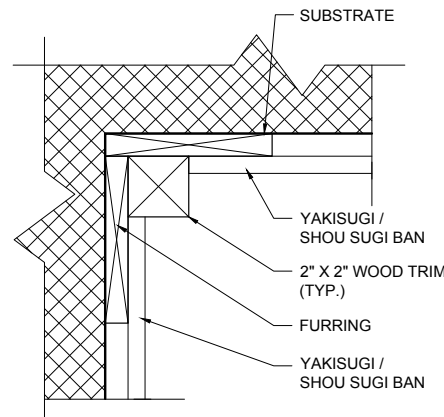

E PLAN VIEW INSIDE CORNER WOOD OPTIONS

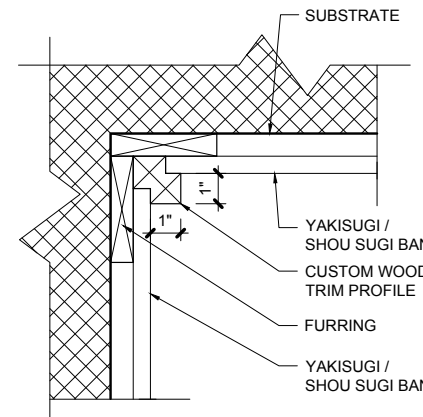

F PLAN VIEW INSIDE CORNER WOOD OPTIONS

GENERAL NOTES:

1. RECOMMENDED PANEL DETAIL EXAMPLES MUST BE ADAPTED FOR VERTICAL AND OTHER INSTALL LAYOUTS.
2. FURRING AND HEADED FACE NAILS REQUIRED FOR ALL EXTERIOR INSTALLATIONS.
3. VERIFY ALL DIMENSIONS AND ELEVATIONS.
4. THESE DETAILS ARE NOT FOR CONSTRUCTION. NAKAMOTO FORESTRY TAKES NO RESPONSIBILITY FOR THE DESIGN AND CONSTRUCTION OF CUSTOMER PROJECTS. THESE DRAWINGS ARE FOR EXAMPLE REFERENCE ONLY.

NOT FOR CONSTRUCTION



Tel. +1-503-512-6780
 Fax +1-503-828-3665
 Email: info@nakamotoforestry.com
 Warehouse & Office - (by Appt. ONLY)
 6400 SE 101st Ave Unit 2C
 Portland OR 97266

Project Title:		Project No.
EXTERIOR INSIDE CORNER WOOD OPTIONS		000-000
Drawn By:		PLM
Date:		11/20/2019
No.	Revision Date	Description
#3	12/02/2019	Beleck Rev.
Drawing No.		N1.04

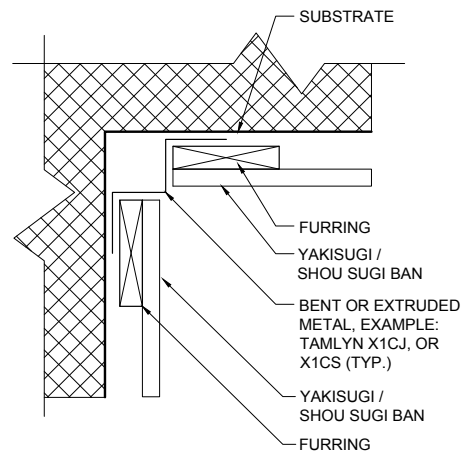
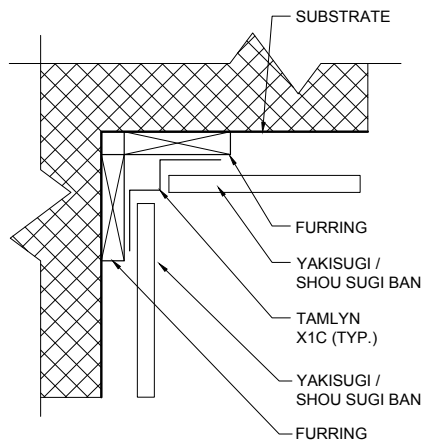

A PLAN VIEW ALUMINUM & METAL OPTIONS

B PLAN VIEW ALUMINUM & METAL OPTIONS

GENERAL NOTES:

1. RECOMMENDED PANEL DETAIL EXAMPLES MUST BE ADAPTED FOR VERTICAL AND OTHER INSTALL LAYOUTS.
2. FURRING AND HEADED FACE NAILS REQUIRED FOR ALL EXTERIOR INSTALLATIONS.
3. VERIFY ALL DIMENSIONS AND ELEVATIONS.
4. THESE DETAILS ARE NOT FOR CONSTRUCTION. NAKAMOTO FORESTRY TAKES NO RESPONSIBILITY FOR THE DESIGN AND CONSTRUCTION OF CUSTOMER PROJECTS. THESE DRAWINGS ARE FOR EXAMPLE REFERENCE ONLY.

NOT FOR CONSTRUCTION



Tel. +1-503-512-6780
 Fax +1-503-828-3665
 Email: info@nakamotoforestry.com
 Warehouse & Office - (by Appt. ONLY)
 6400 SE 101st Ave Unit 2C
 Portland OR 97266

Project Title:		Project No.
EXTERIOR INSIDE CORNER ALUMINUM & METAL OPTIONS		000-000
No.		Revision Date
Description		Date:
#3	02/18/2020	11/20/2019
Beleck Rev.		Drawing No.
		N1.03